

Moteur à engrenages JGB37-550 cc, moteur à couple élevé, moteur à engrenages entièrement en métal 6V 12V

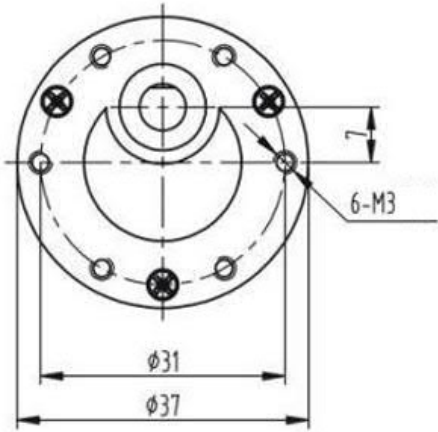
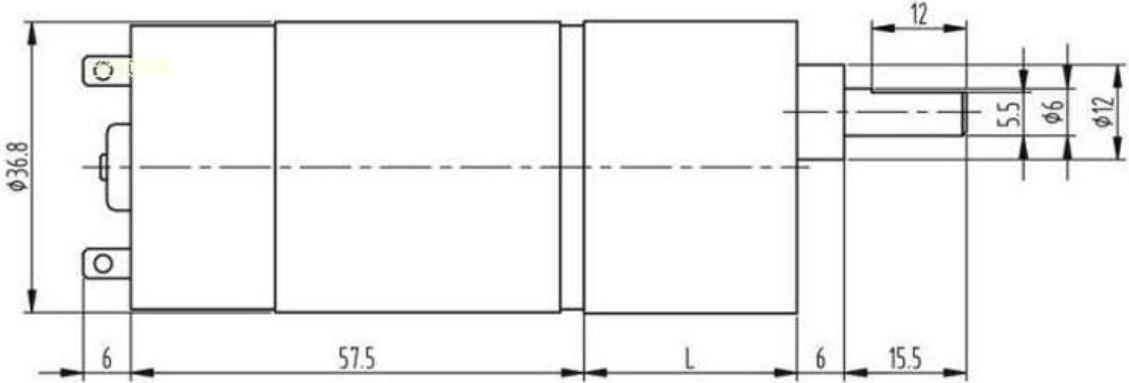

JGB37-550 DC Gear Motor

Rated voltage DC 6V test specification data sheet

Ratio	6.3	10	19	30	56	90	131	168	270	506	810
No-load current (mA)	≤0.9	≤0.9	≤0.9	≤0.9	≤0.9	≤0.9	≤0.9	≤0.9	≤0.9	≤0.9	≤0.9
No-load speed (RPM)	1150	725	380	240	130	80	55	43	26	14	9
Rated torque (kg. cm)	0.5	0.9	1.6	2.5	5.0	7.5	11.0	14.0	20.0	25.0	30.0
Rated speed (RPM)	920	580	240	160	100	64	45	33	20	11	7
Rated current (A)	≤1.5	≤1.5	≤1.5	≤1.5	≤1.5	≤1.5	≤1.5	≤1.5	≤1.5	≤1.5	≤1.5
Maximum torque (kg. cm)	1.0	1.7	3.2	5.0	9.5	15.3	22.0	28.0	35kg. cm maximum		
Stall current (A)	3.0	3	3.0	3.0	3.0	3.0	3.0	3.0	No blocking		
L (MM)	19		22		3		26.5			29	

Rated voltage DC 12V test specification data sheet

Ratio	6.3	10	19	30	56	90	131	168	270	506	810
No-load current (mA)	≤1	≤1	≤1	≤1	≤1	≤1	≤1	≤1	≤1	≤1	≤1
No-load speed (RPM)	2300	1450	770	480	260	160	110	86	53	28	18
Rated torque (kg. cm)	1.2	0.5	1.0	1.5	3.0	4.5	7.0	9.0	14.0	26.0	30.0
Rated speed (RPM)	1900	1160	600	380	200	130	88	69	42	22	14
Rated current (A)	≤2.5	≤2.5	≤2.5	≤2.5	≤2.5	≤2.5	≤2.5	≤2.5	≤2.5	≤2.5	≤2.5
Maximum torque (kg. cm)	2.1	3.4	6.3	10.0	19.0	30.0	35kg. cm maximum				
Stall current (A)	6.0	6	6.0	6.0	6.0	6.0	No blocking				
L (MM)	19		22		24		26.5			29	